

XP-F30

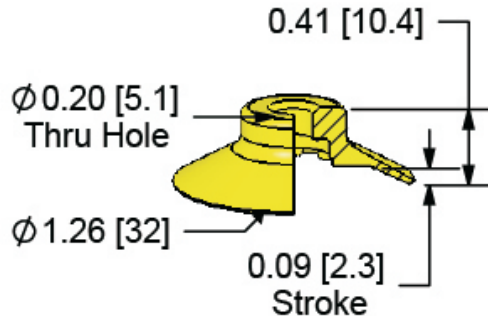

CUP DIAMETER	30 mm
CUP WEIGHT: oz. (g)	0.08 (2.27)
INTERNAL VOLUME: cu. in. (cc)	0.12 (2)
FORCE @ 6" Hg: lb. (N)	2.7 (12)
FORCE @ 18" Hg: lb. (N)	5.6 (24.9)
MINIMUM RADIUS: in. (mm)	0.98 (24.9)
SHEAR LOAD ² : lb. (N)	2.8 (12.5)

MATERIAL - VITON



PART NUMBER

XP-F30V