

# MCHG series



## LOWER HEIGHT of THREE JAW GRIPPERS



### Order example:

**MCHG – 50 M – OS**

MODEL

BODY  
DIAMETER

50  
64  
80  
100  
125  
160

M: Magnet

OS : Mechanical gripping  
force safety device for  
O.D. gripping even with  
a drop pressure

P : Spring-packaged  
pressure plate

### Features:

- Compact, yet rugged design enables high clamping force from the jaws.
- Body manufactured from high tensile, anodised aluminium giving good resistance to corrosion.
- Available with sensors.
- Available with sprung loaded sensor plate.
- Low overall height with long stroke on jaws.

### Specification:

Model	MCHG					
Acting type	Double acting					
Body diameter(mm)	50	64	80	100	125	160
Stroke (mm)	8	12	16	20	26	32
Medium	Air					
Operating pressure range	1~6 kgf/cm <sup>2</sup>					
Ambient temperature	- 10°C ~ + 60°C (No freezing)					
Repeatability	± 0.05 mm					
Lubrication	Not required					
Sensor switch	RH					
Weight (kg)	0.23	0.41	0.8	1.4	2.4	4.7

- Maintenance: Re-Lubrication after appr. 1.5 million cycles recommended.

### Installation of sensor switch:

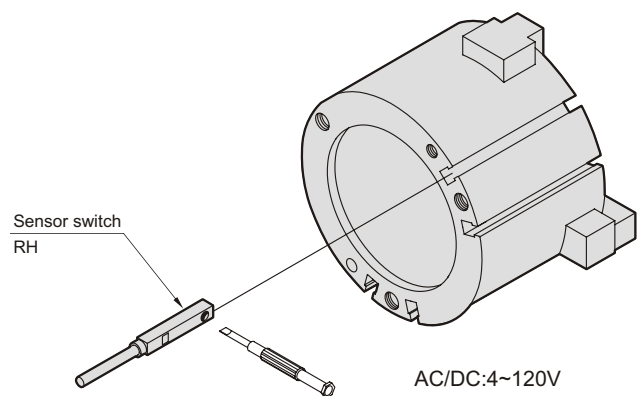

# MCHG Dimensions $\phi 50 \sim \phi 160$



## LOWER HEIGHT of THREE JAW GRIPPERS

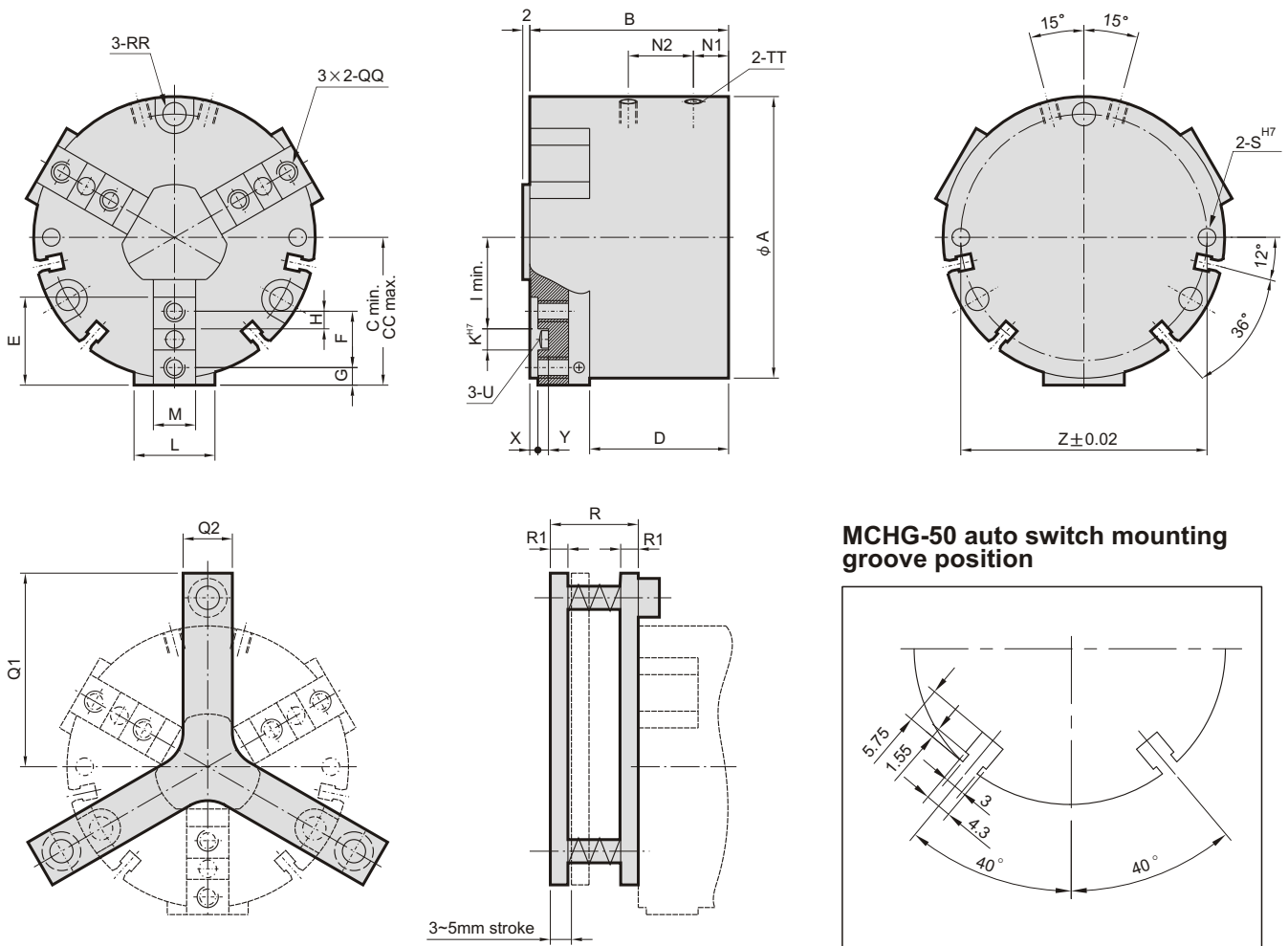

### Spring-packaged Pressure Plate

(P) type

Code Model	A	B	C	CC	D	E	F	G	H	I	K	L	M	N1	N2	Q1	Q2	R	R1
<b>MCHG-50</b>	50	39	26.5	30.5	28	18	12	3	3.5	15	5	14	8.2	8.1	14.8	38	12	25	5
<b>MCHG-64</b>	64	47.5	32	38	32	20	13	4	4	19	5	17	10.2	10	16.5	44	14	25	5
<b>MCHG-80</b>	80	56.5	42	50	39.5	25	16	5	5	26	6	23	12.2	10	22	55	14	25	5
<b>MCHG-100</b>	100	65	52	62	46	32	20	6	6	32	8	27	14.2	12	24	70	20	25	6
<b>MCHG-125</b>	125	76	65.5	78.5	53.5	40	24	8.5	8	41	8	30	16.2	13.5	28.5	85	20	25	6
<b>MCHG-160</b>	160	95	85	101	67	50	32	9	11	55	10	40	20.2	15.5	32.5	100	25	25	6

Code Model	RR	QQ	S	TT	U	X	Y	Z
<b>MCHG-50</b>	$\phi 3.4$ thru, 7C/B $\times$ 5dp P.C.D44	M3 $\times$ 0.5 $\times$ 7dp	$\phi 3 \times 8$ dp	M5	$\phi 4$	-	2	44
<b>MCHG-64</b>	$\phi 5.5$ thru, 10C/B $\times$ 6dp P.C.D56	M4 $\times$ 0.7 $\times$ 8dp	$\phi 4 \times 10$ dp	M5	$\phi 4$	2	2.5	56
<b>MCHG-80</b>	$\phi 6.4$ thru, 11C/B $\times$ 7dp P.C.D70	M5 $\times$ 0.8 $\times$ 9dp	$\phi 5 \times 10$ dp	M5	$\phi 5$	3	3	70
<b>MCHG-100</b>	$\phi 6.6$ thru, 11C/B $\times$ 7dp P.C.D90	M6 $\times$ 1.0 $\times$ 12dp	$\phi 5 \times 12$ dp	PT 1/8	$\phi 6$	3	3	90
<b>MCHG-125</b>	$\phi 8.5$ thru, 15C/B $\times$ 9dp P.C.D112	M6 $\times$ 1.0 $\times$ 12dp	$\phi 6 \times 16$ dp	PT 1/8	$\phi 6$	3	3.5	112
<b>MCHG-160</b>	$\phi 9$ thru, 15C/B $\times$ 9dp P.C.D146	M8 $\times$ 1.25 $\times$ 20dp	$\phi 6 \times 20$ dp	PT 1/8	$\phi 8$	4	4	146

# MCHG-OS Capacity / Dimensions $\phi 50 \sim \phi 160$



## LOWER HEIGHT of THREE JAW GRIPPERS

### Gripping force safety device

Operating pressure min.5 bars,max.6.5 bars

Gripping force = pneum. gripping force + spring force.

Gripping force in relation to the holding position "L" at 6 kgf/cm<sup>2</sup>

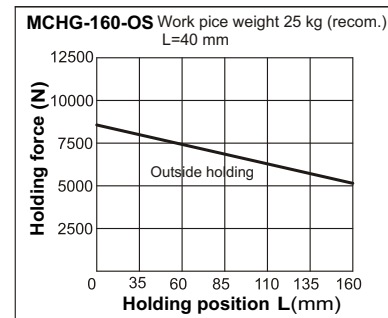
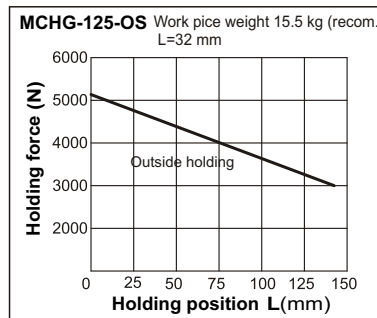
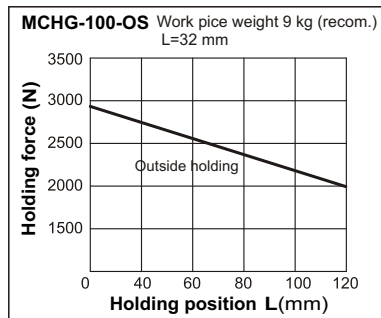
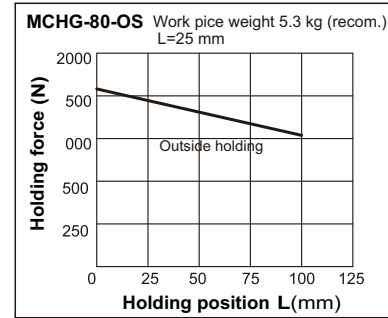
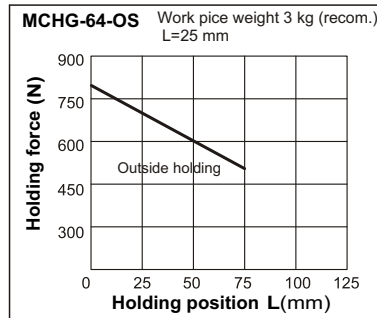
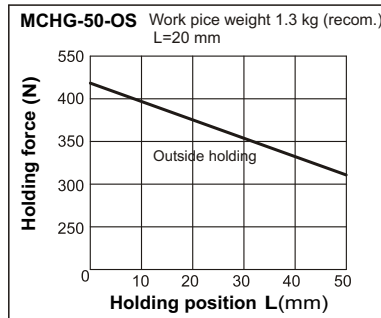

Gripping force safety device for O.D gripping, even with a drop in pressure.

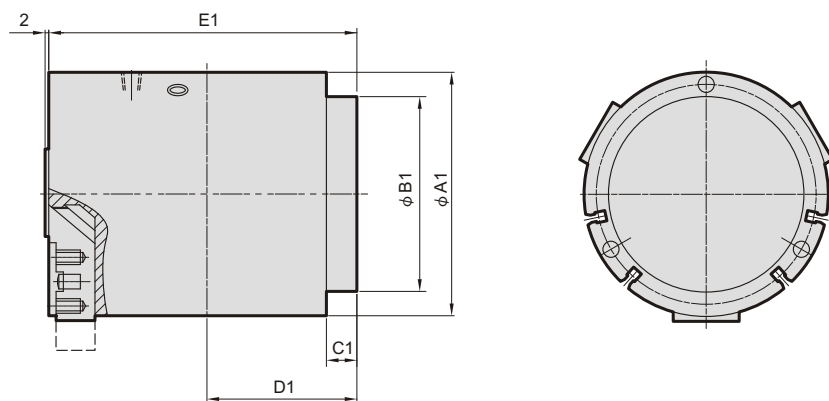

Code Model	A1	B1	C1	D1	E1
<b>MCHG-50</b>	50	—	—	19.2	58.2
<b>MCHG-64</b>	64	45	5	25	72.6
<b>MCHG-80</b>	80	58	5	30.2	87
<b>MCHG-100</b>	100	77	5	32.5	97.5
<b>MCHG-125</b>	125	97	5	37	113
<b>MCHG-160</b>	160	128	5	46	140



## LOWER HEIGHT of THREE JAW GRIPPERS

### Application examples

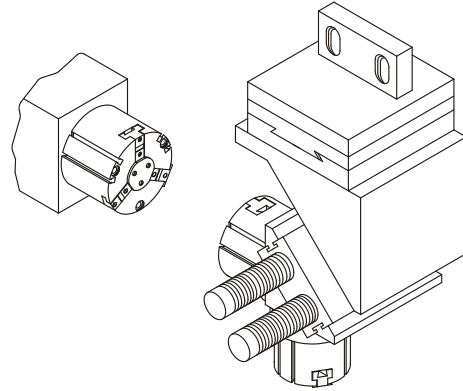
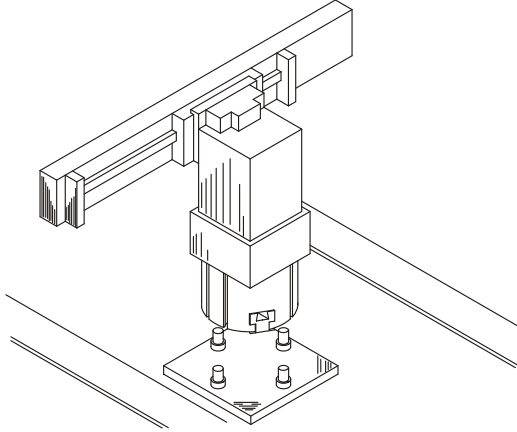

### Finger blanks

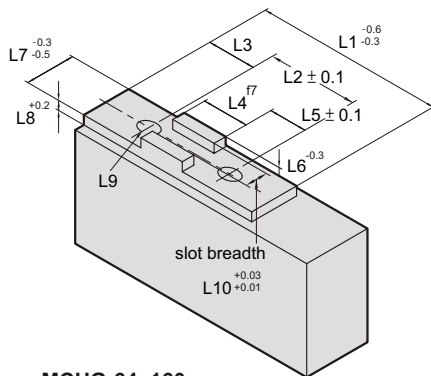

MCHG-64~160

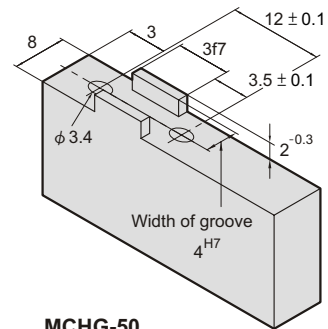

MCHG-50

Code Model	L1	L2	L3	L4	L5	L6	L7	L8	L9	L10
MCHG-50	—	12	3	5	3.5	2	8	—	φ 3.4	4
MCHG-64	20	13	4	5	4	2.5	10.2	4.5	φ 4.5	4
MCHG-80	25	16	5	6	5	3	12.2	5.5	φ 5.5	5
MCHG-100	32	20	6	8	6	3	14.2	5.5	φ 6.6	6
MCHG-125	40	24	8.5	8	8	3.5	16.2	5.5	φ 6.6	6
MCHG-160	50	32	9	10	11	4	20.2	6.5	φ 9	8